

comfee

Wet & Dry Vacuum Cleaner Instruction Manual

CXC05APGY

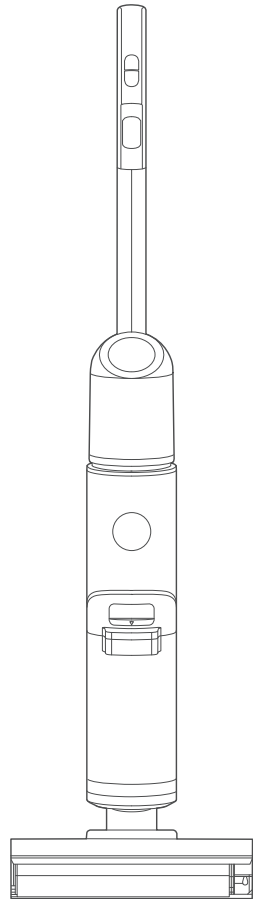

Please read this manual carefully before operating your set and retain it for future reference

CONTENTS

CONTENTS	01
SAFETY INSTRUCTIONS	02
SPECIFICATIONS	06
PRODUCT OVERVIEW	07
PRODUCT INSTALLATION	09
OPERATION INSTRUCTIONS	11
CLEANING AND MAINTENANCE	13
TROUBLE SHOOTING	16

SAFETY INSTRUCTIONS

Intended Use

The following safety guidelines are intended to prevent unforeseen risks or damage from unsafe or incorrect operation of the appliance. Please check the packaging and appliance on arrival to make sure everything is intact to ensure safe operation. If you find any damage, please contact the retailer or dealer. Please note modifications or alterations to the appliance are not allowed for your safety concern. Unintended use may cause hazards and loss of warranty claims.

Explanation of symbols



Danger

This symbol indicates that there are dangers to the life and health of persons due to extremely flammable gas.



Warning of electrical voltage

This symbol indicates that there is a danger to life and health of persons due to voltage.



Warning

The signal word indicates a hazard with a medium level of risk which, if not avoided, may result in death or serious injury.



Caution

The signal word indicates a hazard with a low degree of risk which, if not avoided, may result in minor or moderate injury.



Attention

The signal word indicates important information (e.g. damage to property), but not danger.



Observe instructions

This symbol indicates that a service technician should only operate and maintain this appliance in accordance with the operating instructions.

Read these operating instructions carefully and attentively before using/commissioning the unit and keep them in the immediate vicinity of the installation site or unit for later use!

Important Safety Instructions

• This product is suitable for hard floors in the indoor environment, including waxed floors, stone floors, rubber floors, marble floors, granite floors, terrazzo floors, solid wood floors, composite floors, bamboo floors, as well as glazed tiles, ceramic facing tiles and other flat ground. It may not achieve the best results if the product is used on uneven ground surface.

• Do not use this product near or on the surface of flammable and explosive objects, which may cause fire and explosion.

• Do not use this product near a working fireplace or heater to prevent deformation of the machine casing.

• Do not use it to clean high-temperature substances (unextinguished cigarette butts, matches or hot ash, etc.), ultra-fine substances (such as lime, cement, wood chips, gypsum powder, ashes, charcoal, etc.), dangerous substances (such as solvents, descaling agents, etc.), chemical substances (such as acidic substances, detergents, etc.) and other substances with uncertain physical properties.

• Do not use this floor cleaner to absorb detergent, kerosene, gasoline, alcohol, paint or perfume, or else it may cause short-circuit, fire or explosion.

• Do not use this floor cleaner to absorb toner used in laser printers and copiers, or else it may cause fire or explosion.

• Do not use this floor cleaner to absorb sharp or large objects, such as glass shards, small toys, pins, paper clips, stones, plaster and large pieces of paper, or else it may block up and damage the machine.

• Do not use this floor cleaner to absorb any burning or smoking objects, such as soot from the unextinguished heat source, burning cigarette butts or matches.

This product can't be used to clean stains of strong grease, strong viscosity, or strong dyeing properties such as shoe polish, paint, and pigments.

• Do not touch the plug or any live part of the product with wet hands to avoid the risk of electric shock.

• Stop using it if the plug is damaged. Please call our service personnel for replacement in order to avoid hazards.

Please keep the airflow channels and moving parts of this product away from long hair, loose clothing, fingers and other parts of the body. Do not point the suction tube, accessory tip or tool to the eyes or ears, or put them in the mouth.

Please use the cleaning agent produced by our company and the manufacturer approved by us.

Do not add other solutions to avoid generating toxic and harmful gases.

If electric leakage, motor over-temperature, abnormal noise, peculiar smell or weak suction is found during use, stop using it immediately and call our service personnel.

After using the machine, please clean the wastewater tank in time to avoid peculiar smell, and keep the ventilation path unobstructed, so as to avoid obstruction, or else it will cause the suction power to drop, the motor to heat up, and will affect the service life of the floor cleaner.

After using the machine, please store it in a dry place. A humid place will affect the insulation and service life of the appliance.

Do not soak or rinse the floor cleaner or floor brush in water.

Important Safety Instructions

- This appliance can be used by children aged from 8 years and above and persons with reduced physical, sensory or mental capabilities or lack of experience and knowledge if they have been given supervision or instruction concerning use of the appliance in a safe way and understand the hazards involved.
 - Cleaning and user maintenance shall not be made by children without supervision.
 - Children should not play with the appliance.
 - Please check the suction nozzle regularly. If there is a blockage, please clear it in time to avoid decrease in suction and affecting the performance of the machine.
- Turn off the power before replacing the brush.
- In the following situations, do not use the machine, contact to our customer service center for inspection and repair in time:
 1. Obvious damage or abnormal operation caused by drop;
 2. Power cord is damaged.
 - Do not disassemble the enclosed machine without permission. There are no user serviceable parts. Do not try to change the performance of the machine, or else it will cause danger.
 - Using a voltage that does not match the specifications will cause damage to the product and more likely to cause harm to the user. The correct rated voltage is marked on the nameplate.
 - When cleaning the stairs, be extra cautious to prevent falling.
 - Do not shake or impact the machine up and down to prevent wastewater from flowing into the motor.
 - When the motor is working, do not lift or carry the appliance up and down, and do not put the machine on its side to prevent the wastewater from entering the motor.
- To prevent tip-over, place the machine against the wall after use.
- Do not use the floor cleaner before the clean water tank and wastewater tank are installed properly.
 - Do not place any small objects in the outlet or block the outlet. Remove any small objects that may interfere with the flow of air through the outlet to prevent overheating of the machine.
 - Do not wet the machine body, or it may cause damage and fire due to short circuit.
 - This is only allow to use the docking station for charge the battery.
 - The plug must be removed from the socket-outlet before cleaning or maintaining the appliance.
 - All the technologies and other data in this manual are obtained by our company or the designated third party testing company, and we reserve the right of final interpretation.

Use and Precautions of Washer Detergent

- Mix and clean according to instructions. It is recommended to use cleaning liquid produced by our company or manufacturers approved by our company, which do not contain acid, alkali solutions or substances harmful to the environment.
- If a large amount of cleaning liquid is added, more foam will be generated when used, which may infiltrate into the motor and cause danger.
- The cleaning liquid should be kept out of reach of children. If the cleaning liquid accidentally gets into eyes, rinse thoroughly with clean water; in case of accidental ingestion, seek medical treatment immediately. Follow local environmental protection regulations when handling wastewater and cleaning liquid.

SPECIFICATIONS

Product Model	CXC05APGY
Charging rated input	100-240V~50/60Hz
Charging output	27V \equiv 0.8A
Power	200W
Voltage	22.2V \equiv
Net Weight	3.5kg
Product Size (WxDxH)	270x282x1120mm
Clean water tank volume	800mL
Dirty water tank MAX line volume	400mL

PRODUCT OVERVIEW

Product introduction

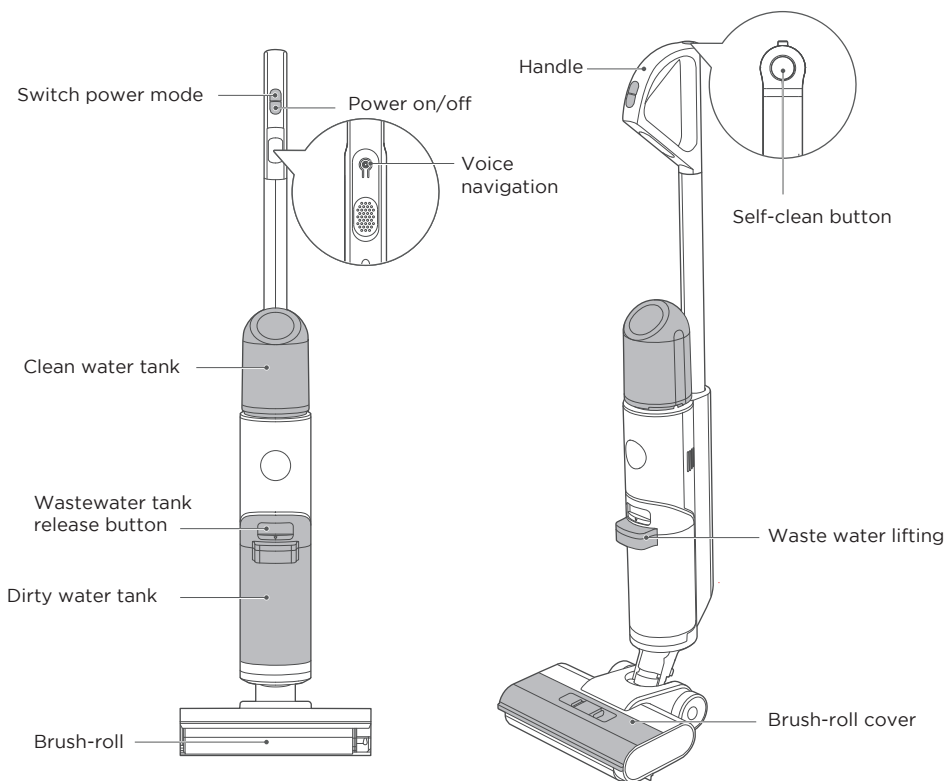

List of Accessories

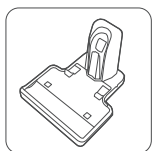

Docking station



Cleaning brush

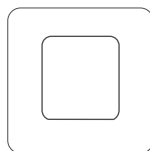

Filter

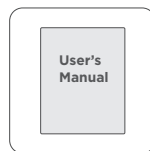

User's Manual

Parts

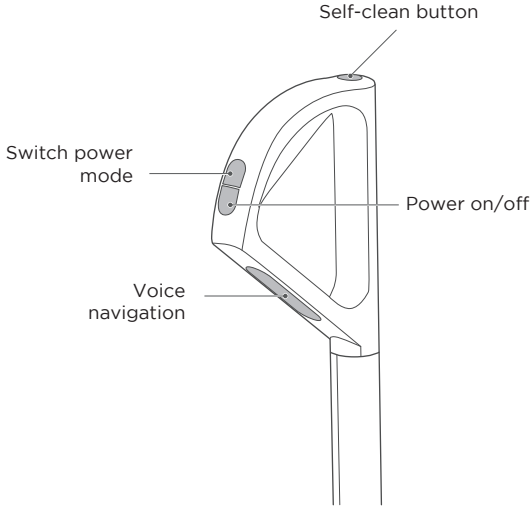

Auto mode

- the water from the machine wets the brush-roll to clean the floor;

Quick suction mode

- the machine stops discharging water, and sucks dry garbage or residual water;

Add the cleaner

- Cleaning and disinfecting agent obtained by means of electrolysis with a dilute sodium chloride solution and it is no harm to the human body and friendly to the human body and friendly to the environment.

PRODUCT INSTALLATION

Handle Installation and Removal

Installation

Insert the end of the handle into the port of the main unit along the vertical direction until there is a click, which indicates the installation is successful;

Removal

Insert a screwdriver or other tools into the hole, and pull out the handle upward.

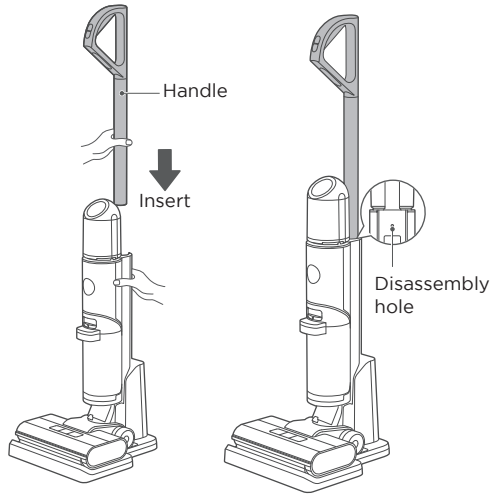

Charging Battery

WARNING

- For the purposes of recharging the battery, only use the detachable supply unit provided with this appliance.

Attention

- Charge the product before the first use.
1. Insert the charging end of the charger into the rear port of the charging dock, and connect the plug to a 100V-240V power
 2. Put the machine upright into the charging base, and make sure that the bottom of the body completely falls into the charging base. At this moment, a voice will prompt "start charging", and the indicator light flashes.
 3. It takes about 3-4 hours to fully charge the machine. When the battery is fully charged, the indicator will turn off and the machine will automatically power off.

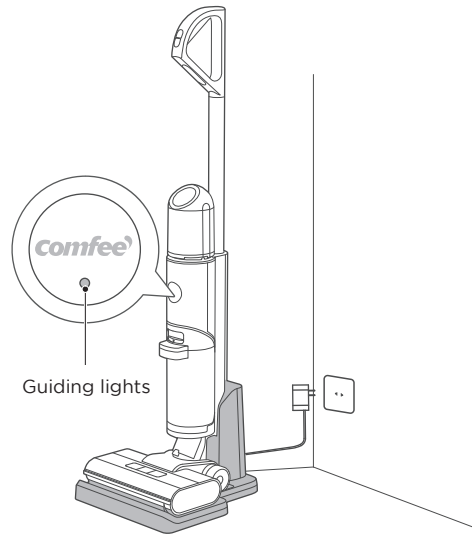



Attention

- Voice cannot be triggered when turned off

4. When the machine is first turned on, the voice function is enabled by default. While in the on or pause state, you can press the voice button to turn off the voice function. Pressing the same button again will re-enable the voice function.

Filling Clean Water Tank



Attention

- Fill water only to the clean water tank.

1. Hold the machine with one hand, grab the water tank with the other hand, rotate and remove the water tank;

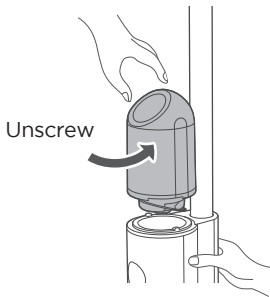

2. Unscrew the water tank cover, pour tap water into the water tank, and add an appropriate amount of cleaning solution if desired;

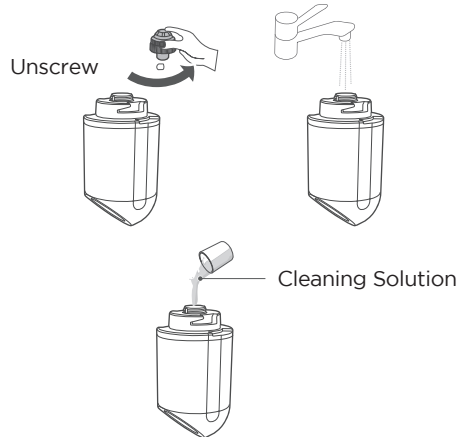

3. Screw the water tank back into place on the machine, and when you hear a click sound, it means the installation is successful.

Screw back into



Screw back into

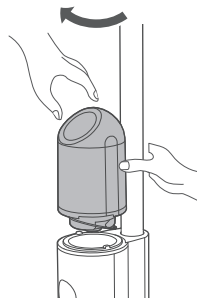

OPERATION INSTRUCTIONS

Turning On and Cleaning

Step 1

Step on the floor brush and pull the handle diagonally until you hear a click. The machine is now in standby mode.

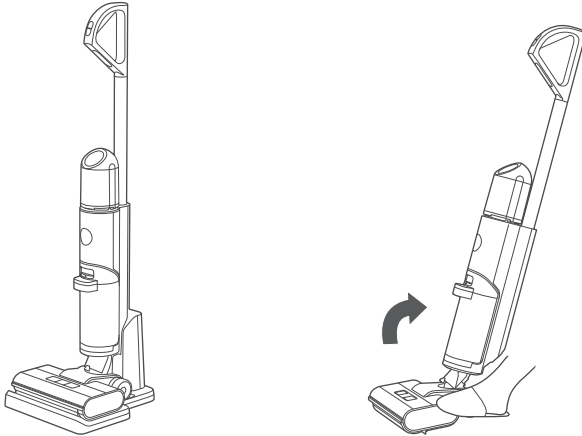

Step 2

To start working, press the power button. Press this button again to stop the machine.

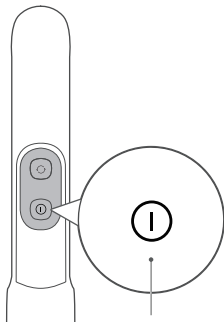

Power button

Step 3

The machine defaults to automatic mode when it starts. To switch to the sterilization mode, press the mode switch button. Press this button again to switch to the suction mode.

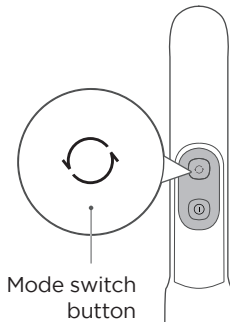

Mode switch button



Attention

- After using the machine, it is recommended to place it vertically on the specially designed charging base.

Upright Pause Function

In working state, you can step on the floor brush to erect the body, the machine will stop working and enter standby state; it will automatically turn off after 2 minutes of standby.

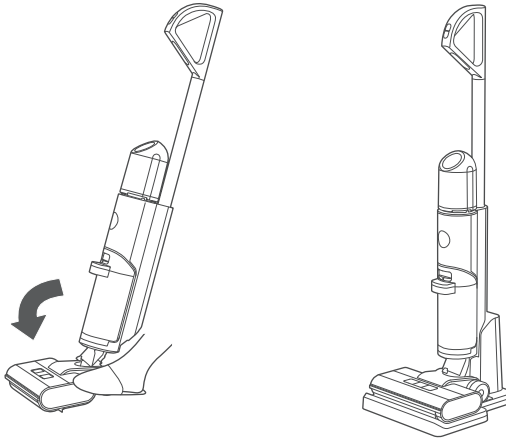

Self-cleaning + Drying Function

⚠ Caution

- During the air-drying process, the machine does not charge. After the air-drying is complete, it automatically enters the charging state. It is normal for the machine to indicate low battery after air-drying in a low battery state.
- In the air-drying mode, to improve the drying effect, the rolling brush will rotate every 2 minutes with a "drip" sound, which is a normal phenomenon.

1. When the machine is in charging state, short press the self-cleaning button to activate the self-cleaning and self-drying mode. During the self-drying process, the roller brush rotates for 30 seconds for centrifugal drying, followed by the low-speed operation of the fan for 90 minutes to properly dry the roller brush and pipeline.
2. When the machine is in charging state, long press the mode switch button for 3 seconds to directly enter the self-drying mode.
3. To stop the self-cleaning or self-drying, press the self-cleaning button again.
4. After the self-cleaning is completed, please clean the wastewater tank in time. If there are residual stains on the base, please clean them in time.

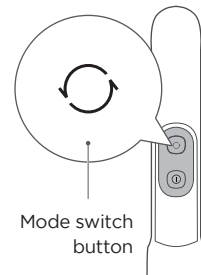

CLEANING AND MAINTENANCE

Waste Water Detect Alarm

Attention

- After cleaning, it is recommended to place the machine upright in the charging base; do not place the machine in places with direct sunlight or moisture;
- In order not to affect the performance of the machine, it is recommended that you regularly maintain its parts;
- Before cleaning, please disconnect the power supply to stop the machine;
- Scrub with water or neutral detergent, wring out the cleaning cloth before scrubbing to avoid water leaking into the electrical components.

1. Press the button of wastewater tank with your thumb and pull outward to remove the tank.

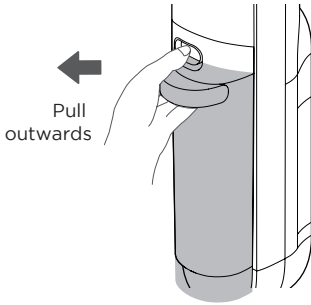

2. Hold the tank with one hand and pull out the top cover of the tank with the other hand.

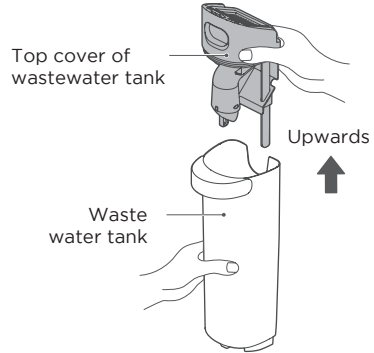

3. Dump the sewage from the side of the sewage tank and rinse it clean; remove the filter from the top cover of the sewage tank, rinse it clean, and air-dry it.

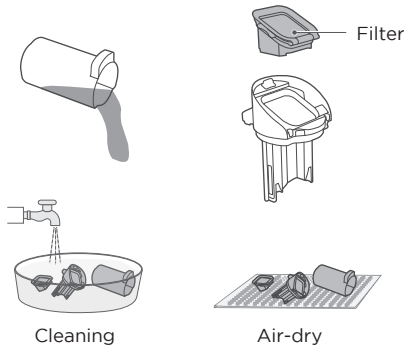

4. Install the wastewater tank back to the machine until there is a click sound; (when installing wastewater tank, it is recommended to hold the body with another hand to avoid tipping over).

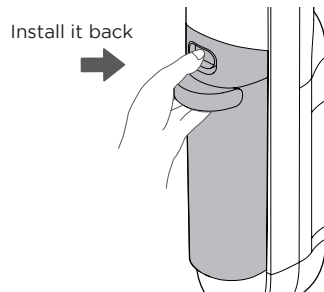

Brush-roll and Cover Cleaning



Attention

- It is recommended that after each use, the roller brush and cover should be cleaned and dried in time;
- If residual stains are found on the suction surface of the floor brush, wipe it with a wet cloth. Do not rinse it with water.

1. Press the buckle as shown in the diagram to remove the floor brush cover;

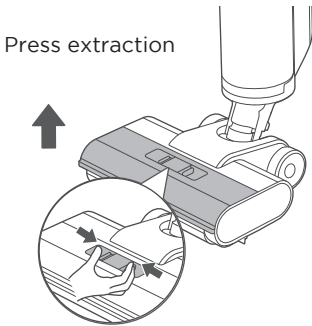

2. Rotate the end cap knob as shown in the diagram and pull out the roller brush sideways;

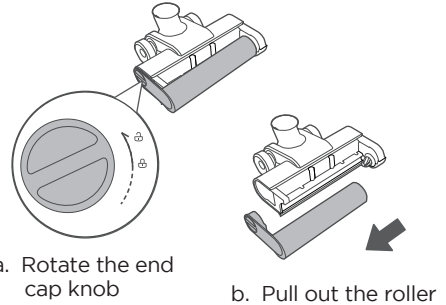

3. If there is still hair or other debris tangled on the roller brush after self-cleaning, remove the tangled debris from the roller brush; for heavy-duty cleaning (such as tomato sauce, soy sauce, etc.), if there is still dirt residue on the roller brush after self-cleaning, it can be self-cleaned again or the roller brush can be removed and cleaned with water;

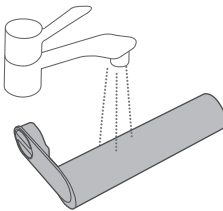

4. If there is residual dirt on the roller brush cover after self-cleaning, rinse the roller brush cover with water.

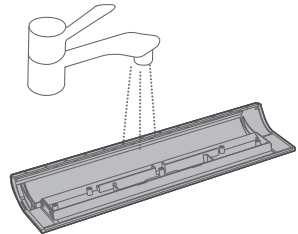

Brush-roll and Cover Cleaning

5. If there are any residual stains on the suction nozzle (the part exposed after removing the roller brush) after self-cleaning, please wipe it with a damp cloth instead of washing it with water.

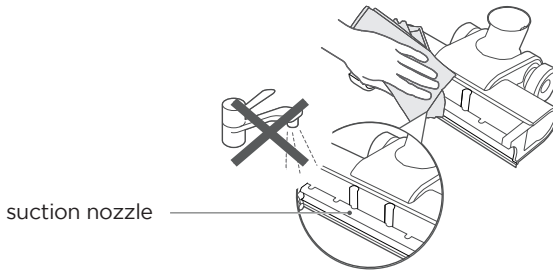

6. After cleaning, reinstall the roller brush. If not in immediate use, you can place the roller brush in a ventilated area to dry before installation.

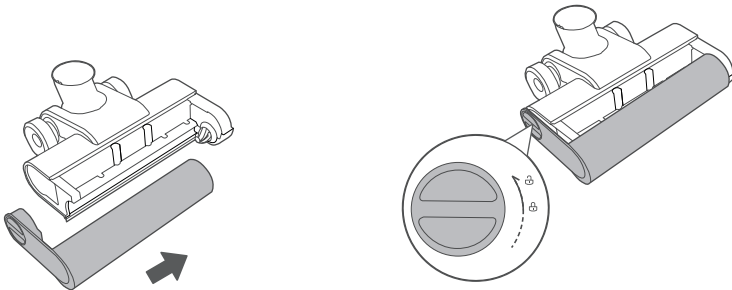

7. After cleaning, cover the floor brush, align it with the installation hole, press it down, and you will hear a click when it is successfully installed.

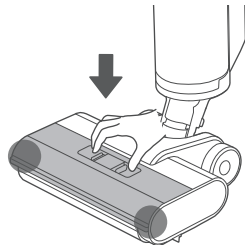

TROUBLESHOOTING

Please check the following table in case of any abnormal conditions when using the product.

Problem	Possible cause	Solution
The floor cleaner does not work	<ul style="list-style-type: none"> The roller brush is entangled by hair or stuck by foreign objects 	Remove the roller brush to clean and reinstall
	<ul style="list-style-type: none"> Wastewater tank is full 	Clean the wastewater tank
	<ul style="list-style-type: none"> Low battery voltage 	Charge
Suction power is weakened	<ul style="list-style-type: none"> Roller brush, roller brush cover, or wastewater tank is not installed in place 	Remove all components and reinstall them
	<ul style="list-style-type: none"> The filter screen above the inside of the sewage tank is dirty 	Use after cleaning the filter screen
	<ul style="list-style-type: none"> Floor brush suction or pipe blockage 	Wipe the floor brush suction and clean the pipe under the air duct
	<ul style="list-style-type: none"> Roller brush is entangled by hair 	Clean the roller brush
	<ul style="list-style-type: none"> Wastewater tank filter is dirty 	Clean the filter and dry thoroughly before installation
Noise when the fan is running	<ul style="list-style-type: none"> Foreign matter in the suction port of the floor brush or in the pipe 	Wipe the suction port and clean the pipe under the air duct
	<ul style="list-style-type: none"> Wastewater tank is full 	Clean the Wastewater tank
Floor brush doesn't spray water	<ul style="list-style-type: none"> Water shortage in clean water tank 	Add water to the clean water tank
	<ul style="list-style-type: none"> Clean water tank is not installed properly 	Reinstall the clean water tank
Air outlet leaks water	<ul style="list-style-type: none"> Wastewater tank filter is cleaned and not dried after use 	Clean the filter and dry thoroughly before installation
Water leakage at the bottom of floor brush	<ul style="list-style-type: none"> Wastewater tank or filter isn't installed 	Install wastewater tank and filter

Made in China

<https://www.feelcomfee.com/hk>

comfee

多功能洗地 吸塵機

使用說明書

CXC05APGY

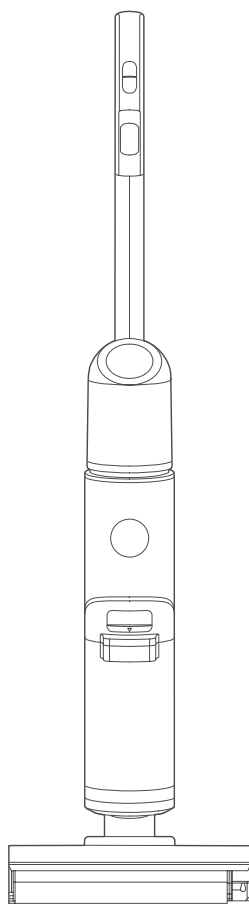

在操作您的設備之前，請仔細閱讀本說明書，並妥善保存以備日後查閱。

目錄

目錄.....	01
安全須知.....	02
規格.....	06
產品概述.....	07
產品安裝.....	09
操作說明.....	11
清潔和保養.....	13
故障排除.....	16

安全須知

預期用途

以下安全指南旨在防止不安全或不正確的設備操作造成的不可預見的風險或損壞。到貨時請檢查包裝和用具，確保一切完好無損，以確保安全操作。如果發現任何損壞，請聯繫零售商或經銷商。請注意，出於安全考慮，不允許對設備進行改裝或更改。非預期使用可能導致危害和保修索賠損失。

符號說明



危險

此標誌表示含有極度易燃的氣體，對人體和健康具有危害性。



電壓警告

該符號表示電壓，對人體和健康有危害性。



警告

該標語表示具有中度的危險，如不加以避免，可能導致死亡或嚴重傷害。



注意

該標語表示具有低度的危險，如不加以避免，可能導致輕度或中度傷害。



注意事項

該標語表示其為重要信息（如可能造成財產損失），但不表示危險。



遵守指示

該符號表示維修人員只能根據操作說明操作和保養本設備。

在使用或調試設備前，請仔細閱讀本說明書的操作說明，並將說明書保存在設備安裝地點或設備附近，以備日後查閱！

重要安全須知

- 本產品適用於室內環境的硬質地板，包括打蠟地面、石材地面、橡膠地面、大理石地面、花崗巖地面、水磨石地面、實木地板、複合地板、竹地板以及釉面磚、陶瓷飾面磚等平坦地面。如果在不平坦的地面上使用，可能不會達到最佳效果。
- 請勿在易燃易爆物品附近或其表面使用本產品，這可能會引起火災和爆炸。
- 請勿在正在工作的壁爐或加熱器附近使用本產品，以防止機器外殼變形。
- 請勿將產品用於清潔高溫物質（未熄滅的煙頭、火柴或熱灰等）、超細物質（如石灰、水泥、木屑、石膏粉、灰燼、木炭等）、危險物質（如溶劑、除垢劑等）、化學物質（如酸性物質、洗滌劑等）以及其他物理性質不確定的物質。
- 請勿使用本地板清潔器吸收洗滌劑、煤油、汽油、酒精、油漆或香水，否則可能導致短路、火災或爆炸。
- 請勿使用本地板清潔器吸收激光打印機和複印機中使用的墨粉，否則可能導致火災或爆炸。
- 請勿使用本地板清潔器吸收尖銳或較大的物體，如玻璃碎片、小玩具、別針、回形針、石頭、石膏和大張紙等，否則可能會造成堵塞並損壞機器。
- 請勿使用本地板清潔器吸收任何燃燒或冒煙的物體，例如未熄滅的熱源、正在燃燒的煙頭或火柴產生的煙灰。
- 本產品不能用於清潔強油脂、強粘度或強染色性的汙漬，如鞋油、油漆和顏料。
- 請勿用濕手觸摸插頭或產品的任何帶電部件，以免觸電。
- 如果插頭損壞，請停止使用。請致電本公司服務人員進行更換，以避免危險。
- 請將本產品的氣流通道和運動部件遠離長髮、寬鬆衣物、手指等身體部位。請勿將吸管、附件尖端或工具指向眼睛或耳朵，也不要放入嘴裏。
- 請使用本公司和本公司認可的製造商生產的清潔劑。
- 請勿添加其他溶液，以免產生有毒有害氣體。
- 如果在使用過程中發現漏電、電機過溫、異常噪音、異味或吸力減弱，請立即停止使用並致電本公司客戶服務部
- 機器使用後，請及時清理廢水箱，避免異味，並保持通風路徑通暢，以免造成堵塞；否則會導致吸力下降、電機發熱，影響該地板清潔器的使用壽命。
- 機器使用後，請存放在乾燥處。潮濕的場所會影響電器的絕緣和使用壽命。
- 不要在水中浸泡或沖洗該地板清潔器或地板刷。

重要安全須知

• 八歲或以下兒童，肢體、感官或精神機能減退人員，以及缺乏相關經驗和知識的人員，需在他人監督和指導下，了解相關危險，方可安全地使用本設備。

• 兒童不得在無人看管的情況下對本設備進行清潔和保養。

• 不可讓兒童玩本設備。

• 請定期檢查吸嘴。若有堵塞，請及時清理，以免吸力下降而影響機器性能。

• 更換清潔刷前請關閉電源。

• 在下列情況下，請勿使用該機器，應及時聯繫本公司客戶服務中心進行檢查和維修：

1. 跌落造成明顯損壞或工作不正常；

2. 電源線損壞。

• 請勿私自拆卸封閉式機器。沒有用戶可維修的零件。不要試圖改變機器的性能，否則會造成危險。

• 使用與規格不符的電壓會造成產品損壞，更有可能對用戶造成傷害。銘牌上標有正確的額定電壓。

• 清潔樓梯時，應格外小心，防止跌落。

• 請勿上下晃動或撞擊機器，防止廢水流入機內。

• 使用設備時，請勿升降或搬運設備，也不要將機器側放，防止廢水進入機內。

為防止傾翻，使用後應將機器靠牆放置。

• 清水箱和廢水箱未正確安裝前，請勿使用洗地吸塵機。

• 請勿在出風口內放置任何小物品或堵塞出風口。移除任何可能干擾氣流通過出口的小物體，以防止機器過熱。

• 請勿弄濕機身，否則會因短路而造成損壞和火災。

• 允許使用充電座為電池充電。

• 清潔或保養設備前，必須將插頭從插座上拔出。

• 本說明書中的所有技術和其他數據均由本公司或指定的第三方檢測公司獲得，本公司保留最終解釋權。

洗滌液的使用及注意事項

- 按照說明進行混合和清潔。建議使用本公司或本公司認可的製造商生產的清潔液，不含酸、鹼溶液或對環境有害的物質。
- 如果加入大量的清潔液，使用時會產生更多的泡沫，可能會滲入電機內部造成危險。
- 清潔液應放在兒童捉摸不到的地方。如果清潔液不慎進入眼睛，用清水徹底沖洗；如果誤食，請立即就醫。處理廢水和清潔液時，應遵守當地的環保法規。

規格

產品型號	CXC05APGY
充電額定輸入	100-240V ~ 50/60Hz
充電輸出	27V \equiv 0.8A
電源	200W
電壓	22.2V \equiv
淨重	3.5kg
產品尺寸 (闊x高x深)	270x282x1120mm
清水箱容積	800ml
廢水箱容積	400ml

產品概述

產品介紹

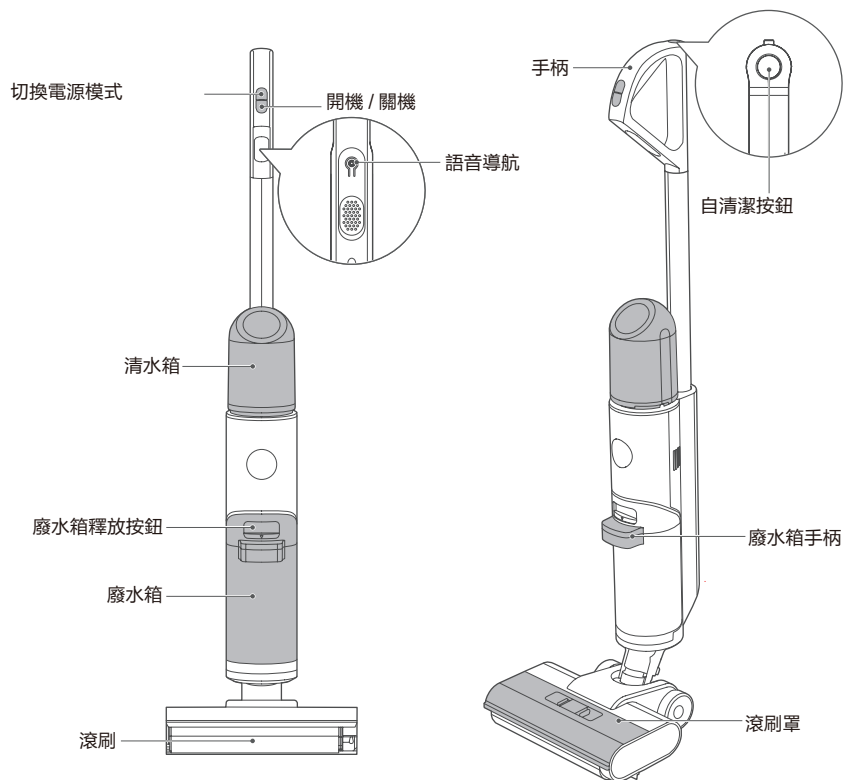

附件清單

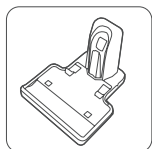

充電底座

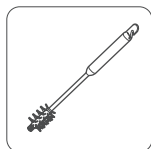

清潔刷

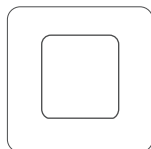

過濾器

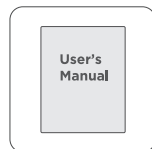

使用說明書

零件

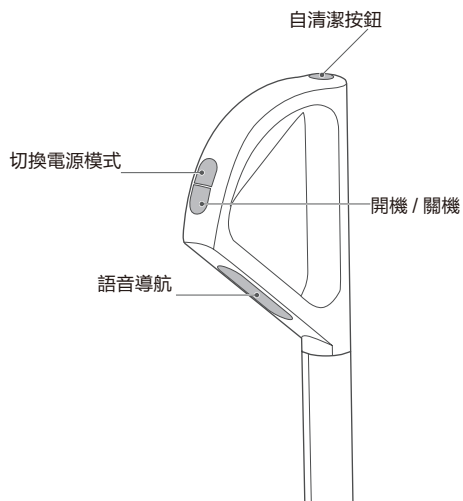

自動模式

- 機器出水打濕滾刷以清潔地面；

快速抽吸模式

- 機器停止排水，吸入乾垃圾或殘留水；

電解水

- 用稀氯化鈉溶液電解得到清潔消毒劑，其對人體無害、對人體友好且環保。

產品安裝

拉手安裝與拆卸

安裝

將手柄端部沿垂直方向插入主機端口，聽到“咔嗒”聲表示安裝成功；

拆卸

將螺絲刀或其他工具插入孔中，向上拉出手柄。

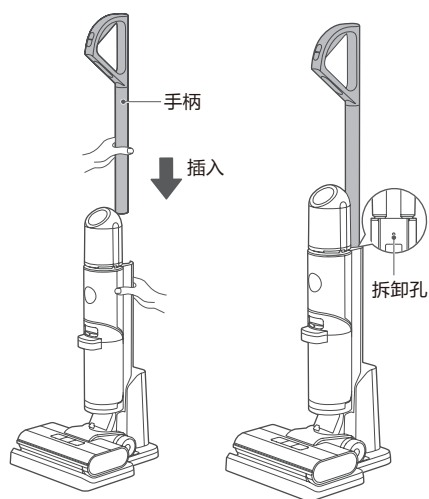

充電電池

● 注意事項

- 首次使用前請給產品充電。

1. 將充電機的充電端插入充電座後端口，插頭接入 220V~240V 電源
2. 將機器直立放入充電座，確保機身底部完全落入充電座內。此時，語音提示“開始充電”，指示燈閃爍。
3. 機器充滿電大約需要 3-4 個小時。當電池充滿電時，指示燈熄滅，機器自動斷電。
4. 首次開機時，默認開啓語音功能。在開啓或暫停狀態下，可按語音按鈕關閉語音功能。再次按下該按鈕，將重新啓用語音功能。

● 注意事項

- 關閉時無法觸發語音

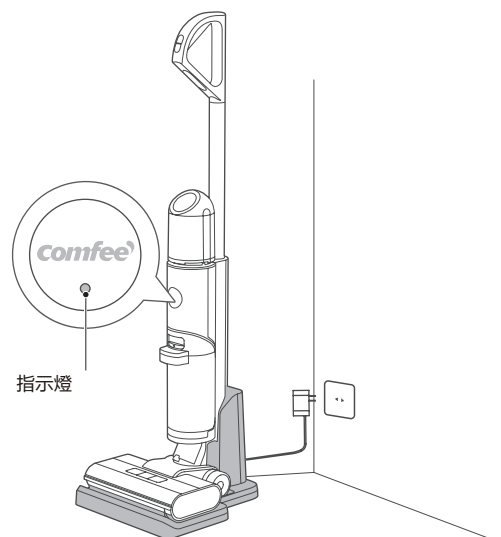

加注清水箱



注意事項

- 僅向清水箱注水。

1. 一手扶住機器，另一手抓住水箱，旋轉取下水箱；
2. 擰開水箱蓋，將自來水倒入水箱內，按需要加入適量清潔液；

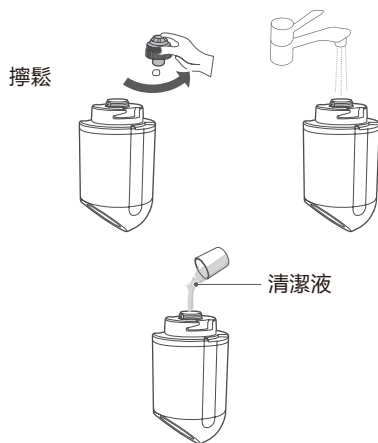

3. 將水箱擰回機器上原位，聽到“咔嗒”聲表示安裝成功。

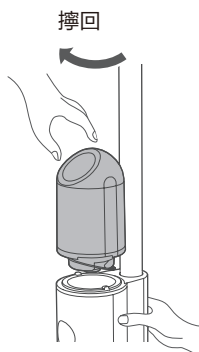

操作說明

開啓和清潔

第 1 步

踩下地板刷，對角拉動手柄直至聽到“咔嗒”聲，此時機器處於待機模式。

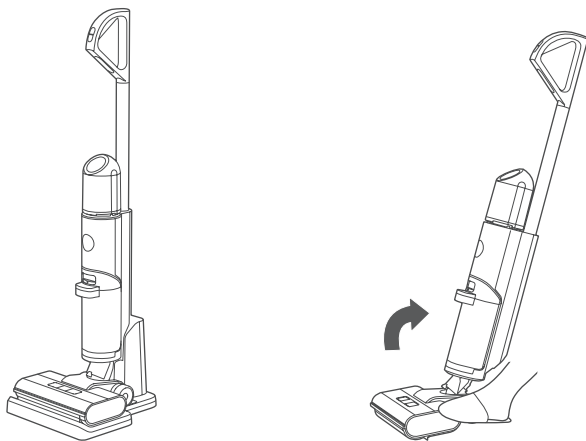

第 2 步

請按電源按鈕開始工作。再次按下電源按鈕，機器停止工作。

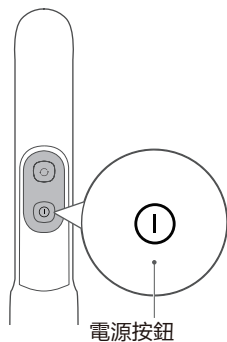

第 3 步

機器啓動時默認為自動模式。要切換到滅菌模式，請按下模式開關按鈕。再次按下此按鈕可切換到抽吸模式。

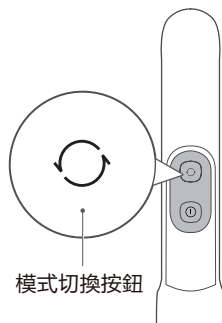

注意事項

- 使用後，建議垂直放置在專用的充電座上。

直立暫停功能

在工作狀態下，可踩下地板刷豎立機身，機器停止工作進入待機狀態；待機 2 分鐘後自動關機。

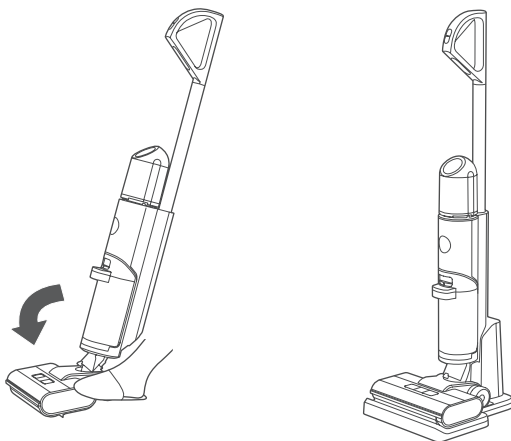

自清潔 + 風乾功能

⚠ 注意

- 風乾過程中，機器不充電。風乾完成後，自動進入充電狀態。低電量狀態下風乾後機器顯示電池電量不足屬正常現象。
- 在風乾模式下，為提高風乾效果，滾刷會每 2 分鐘轉動一次，發出“滴”的聲音屬正常現象。

1. 機器處於充電狀態時，短按自清潔按鈕，進入自清潔自風乾模式。自風乾過程中，滾刷旋轉 30 秒進行離心風乾，然後風機低速運行 90 分鐘，使滾刷及管路適當乾燥。
2. 機器處於充電狀態時，長按模式開關按鈕 3 秒鐘，直接進入自風乾模式。
3. 再次按下自清潔按鈕可停止自清潔或自風乾。
4. 自清潔完成後，請及時清理廢水箱。如果底座上有殘留污漬，請及時清理。

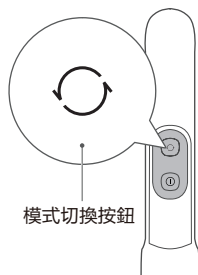

清潔和保養

廢水檢測警報

● 注意事項

- 清潔後，建議將機器直立放置在充電座內；請勿將機器放置在陽光直射或潮濕的地方；
- 為了不影響機器的性能，建議您定期保養其零件；
- 清潔前，請斷開電源停機；
- 用水或中性洗滌劑擦洗，擦洗前將抹布擰乾，以免水漏入電氣元件。

1. 用拇指按下廢水箱按鈕，向外拉即可拆下。

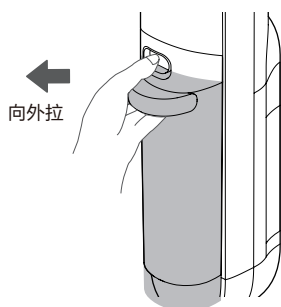

2. 一手扶住水箱，另一手拉出水箱頂蓋。

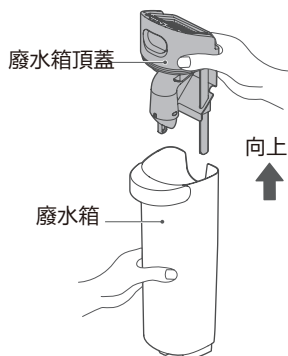

3. 將廢水從污水箱側面傾倒並沖洗乾淨；從廢水箱頂蓋上拆下過濾器，沖洗乾淨，風乾。

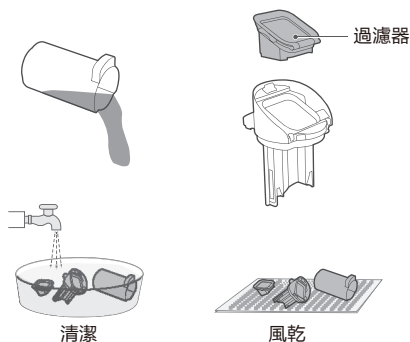

4. 將廢水箱裝回機器，直至聽到“咔嗒”聲；（安裝廢水箱時建議另一手扶住機身以免傾倒）。



滾刷和蓋的清潔



注意事項

- 建議每次使用後，及時清潔並風乾滾刷和蓋子；
- 如果發現地板刷的吸入口表面有殘留污漬，用濕布擦拭。切勿用水沖洗。

1. 如圖所示按壓卡扣，拆下地板刷蓋；

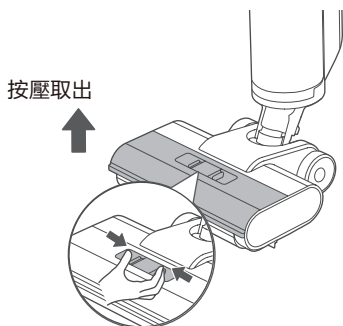

2. 如圖所示旋轉端蓋旋鈕，將滾刷側向拉出；

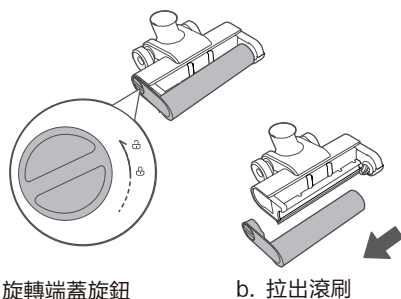

3. 若自清潔後滾刷上仍有毛髮或其他雜物纏繞，則清除滾刷上纏結的雜物；對於強力清潔（如番茄醬、醬油等），若自清潔後滾刷上仍有污垢殘留，可再次自清潔或拆下滾刷用水清洗；

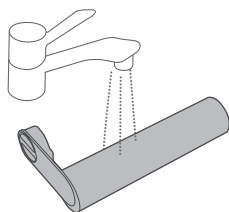

4. 如果自清潔後滾刷罩上有殘留污垢，用水沖洗。

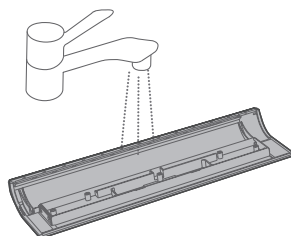

滾刷和蓋的清潔

5. 如果自清潔後吸嘴（拆下滾刷後暴露的部分）上有殘留污漬，請用濕布擦拭，不要用水沖洗。

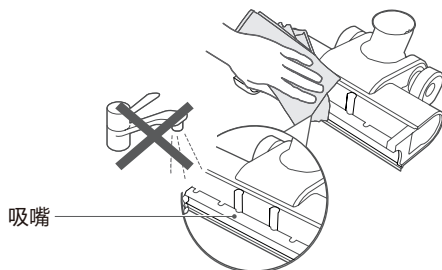

6. 清潔後，重新安裝滾刷。如果不立即使用，可在安裝前將滾刷放置在通風處晾乾。

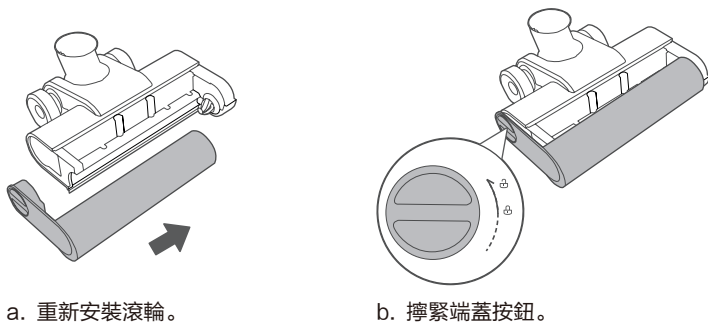

7. 清潔完畢後，蓋上地板刷，對準安裝孔，向下按壓，安裝成功時會聽到“咔嗒”聲。

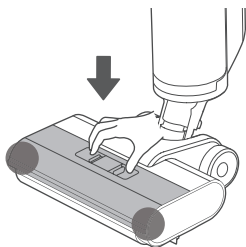

故障排除

使用本產品時如有異常情況，請查看下表。

問題	可能原因	解決方案
洗地吸塵機沒有運作	• 滾刷被毛髮纏住或有異物卡住	拆下滾刷進行清潔並重新安裝
	• 廢水箱已滿	清洗廢水箱
	• 電池電量低	充電
吸力減弱	• 滾刷、滾刷罩或廢水箱安裝不到位	拆下所有部件並重新安裝
	• 廢水箱箱內部上方濾網髒	清洗濾網後再使用
	• 地板刷入口或管道堵塞	擦拭地板刷入口，清潔風道下方管道
	• 滾刷被毛髮纏住	清潔滾刷
	• 廢水箱過濾器髒	安裝前清潔過濾器並徹底乾燥
風機運轉時有噪音	• 地板刷入口或管道內有異物	擦拭入口，清潔風道下方管道
	• 廢水箱已滿	清洗廢水箱
地板刷不噴水	• 清水箱缺水	給清水箱加水
	• 清水箱安裝不當	重新安裝清水箱
出風口漏水	• 廢水箱過濾器使用後清洗了但未風乾	安裝前清潔過濾器並徹底風乾
地板刷底部漏水	• 未安裝廢水箱或過濾器	安裝廢水箱和過濾器

Made in China

<https://www.feelcomfee.com/hk>